

Ben Allman  
Estate & Letting Agents



## 10 Woodcroft Close

Sproston, Norwich, NR7 9HS

Offers in excess of £235,000



## Floor Plan

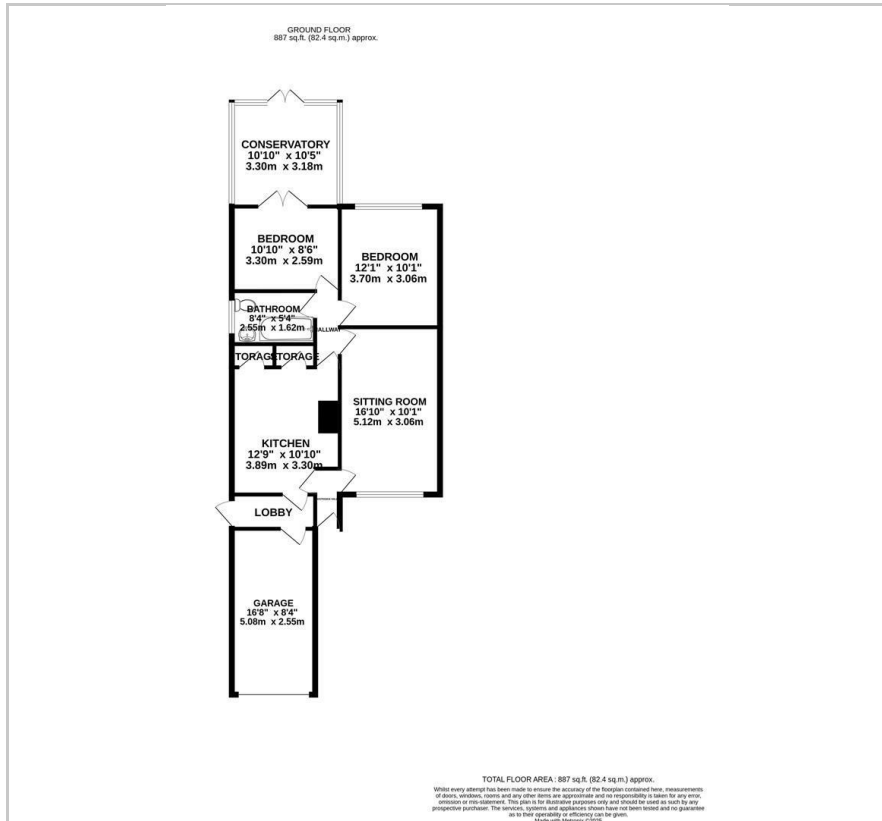

## Area Map



## Energy Efficiency Graph

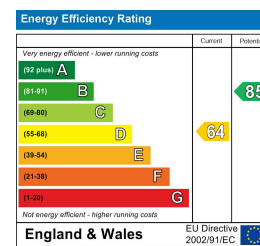

## Viewing

Please contact our Ben Allman Estate Agents Office on 01603 555577 if you wish to arrange a viewing appointment for this property or require further information.

- Detached Bungalow
- No Onward Chain
- Two Double Bedrooms
- Conservatory
- Recently Upgraded Bathroom
- Recently Upgraded Kitchen (Worktops And Tiling)
- Integral Garage With Power
- Enclosed Rear Garden
- Cul-De-Sac Location
- EPC Rating - D

Situated down a quiet cul-de-sac is this detached bungalow, benefiting from two double bedrooms, an integral garage and a conservatory.

Offered with no onward chain, this detached bungalow has undergone various improvements from the current owner, including a new bathroom suite, upgraded kitchen worktops, ceramic sink, tiling and a recent damp-proof course.

The accommodation comprises of a large sitting room, kitchen/breakfast room, lobby, integral garage with power, two double bedrooms and a conservatory leading off bedroom two. There is an enclosed rear garden with mature shrubs and a further lawned front garden and driveway for off-road parking. Located within a quiet cul-de-sac within the popular suburb of Sprowston, the property is ready to move straight in to, so be quick to arrange your internal viewing!

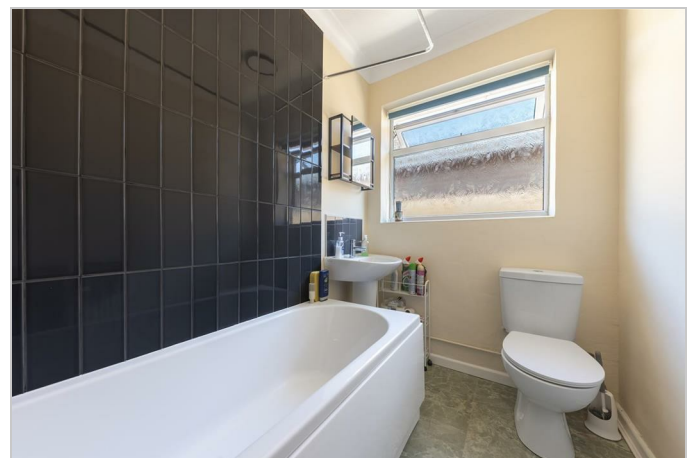

These particulars, whilst believed to be accurate are set out as a general outline only for guidance and do not constitute any part of an offer or contract. Intending purchasers should not rely on them as statements of representation of fact, but must satisfy themselves by inspection or otherwise as to their accuracy. No person in this firm's employment has the authority to make or give any representation or warranty in respect of the property.

2B Sprowston Road, Norwich, Norfolk, NR3 4QN  
Tel: 01603 555577 Email: enquiries@baela.co.uk www.baela.co.uk